

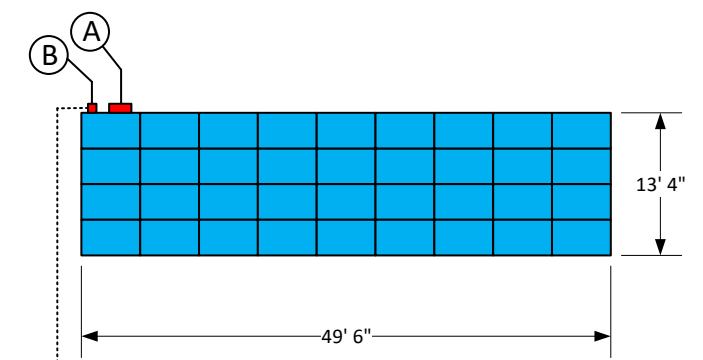

# ARRAY LAYOUT & SITE PLAN

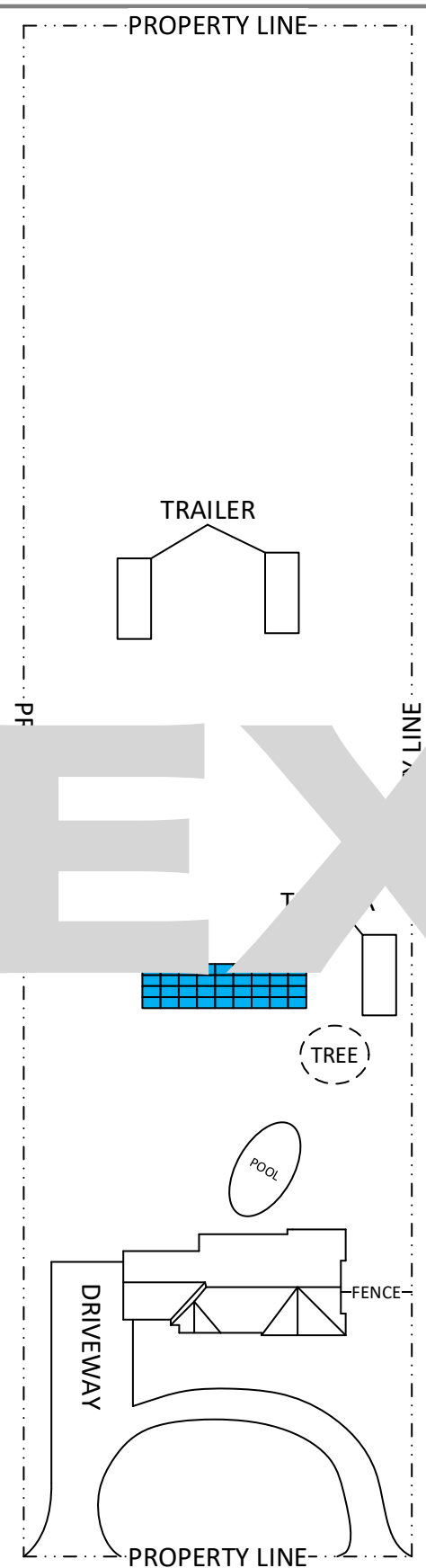

EXAMPLE

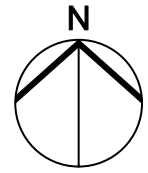
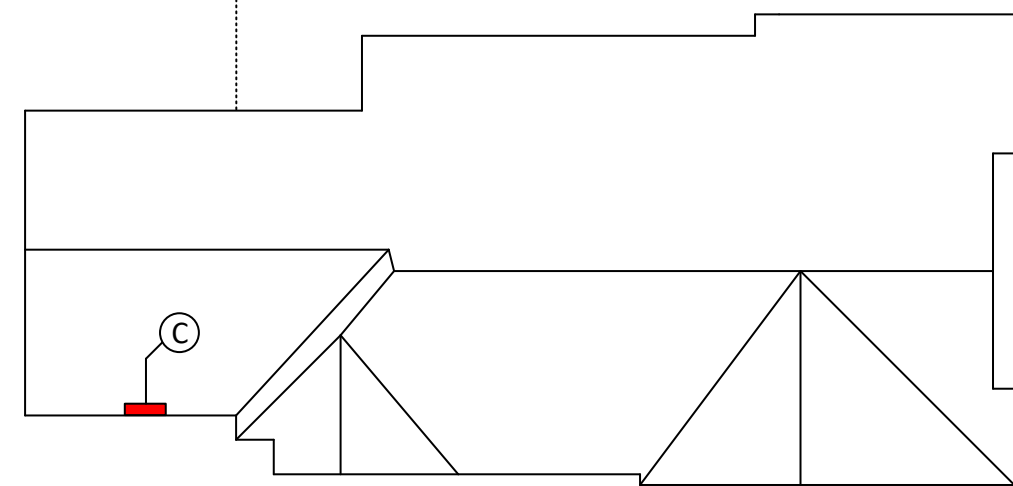

### EQUIPMENT LOCATIONS:

- (A) INVERTER
- (B) UTILITY AC DISCONNECT
- (C) SERVICE PANEL IN GARAGE

### NOTES:

-ANY NEW ELECTRICAL EQUIPMENT SHALL BE A MINIMUM OF 3' AWAY FROM GAS METER.

Location of ( 36 ) REC REC290TP2 BLK modules	
Ground Mount Total Area: 647 : SqFT	
OCCUPANY: R3/U	AREA SQ FT: 647
CONSTRUCTION TYPE: VB	

DRAFTED BY:  
B.S.  
CHECK BY:  
C.G.  
DRAFTED:  
2/9/18

OWNER BUILDER

10.44 kWDC  
Photovoltaic  
System

SHEET:  
PV: 1.2



# Grounding & Attachment Detail

Face-on View of PV Array, Typical of One

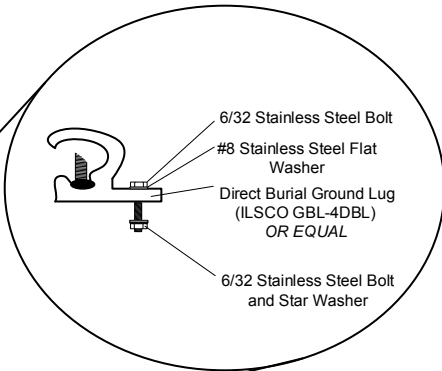
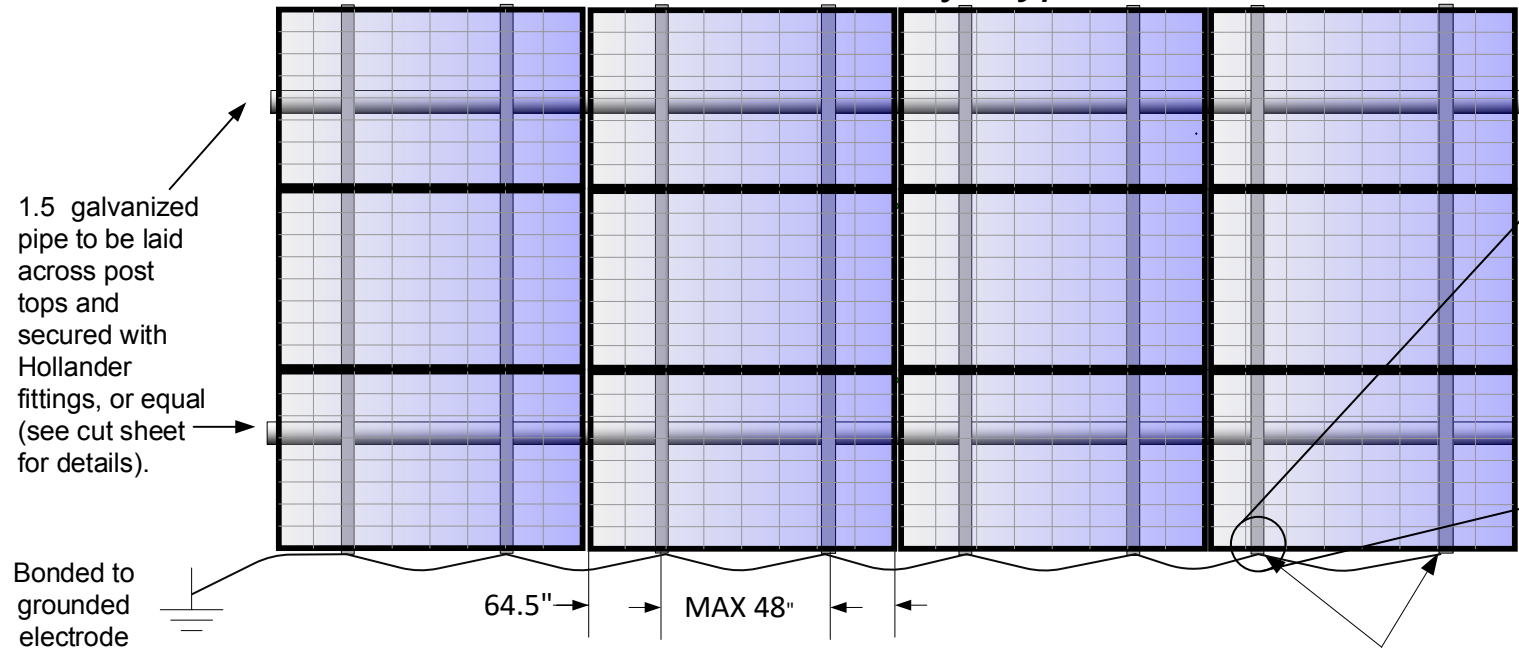

Rail to be laid perpendicular over galvanized pipe. Support rail secured to 1.5" galvanized pipe with stainless steel U-

EXAMPLE

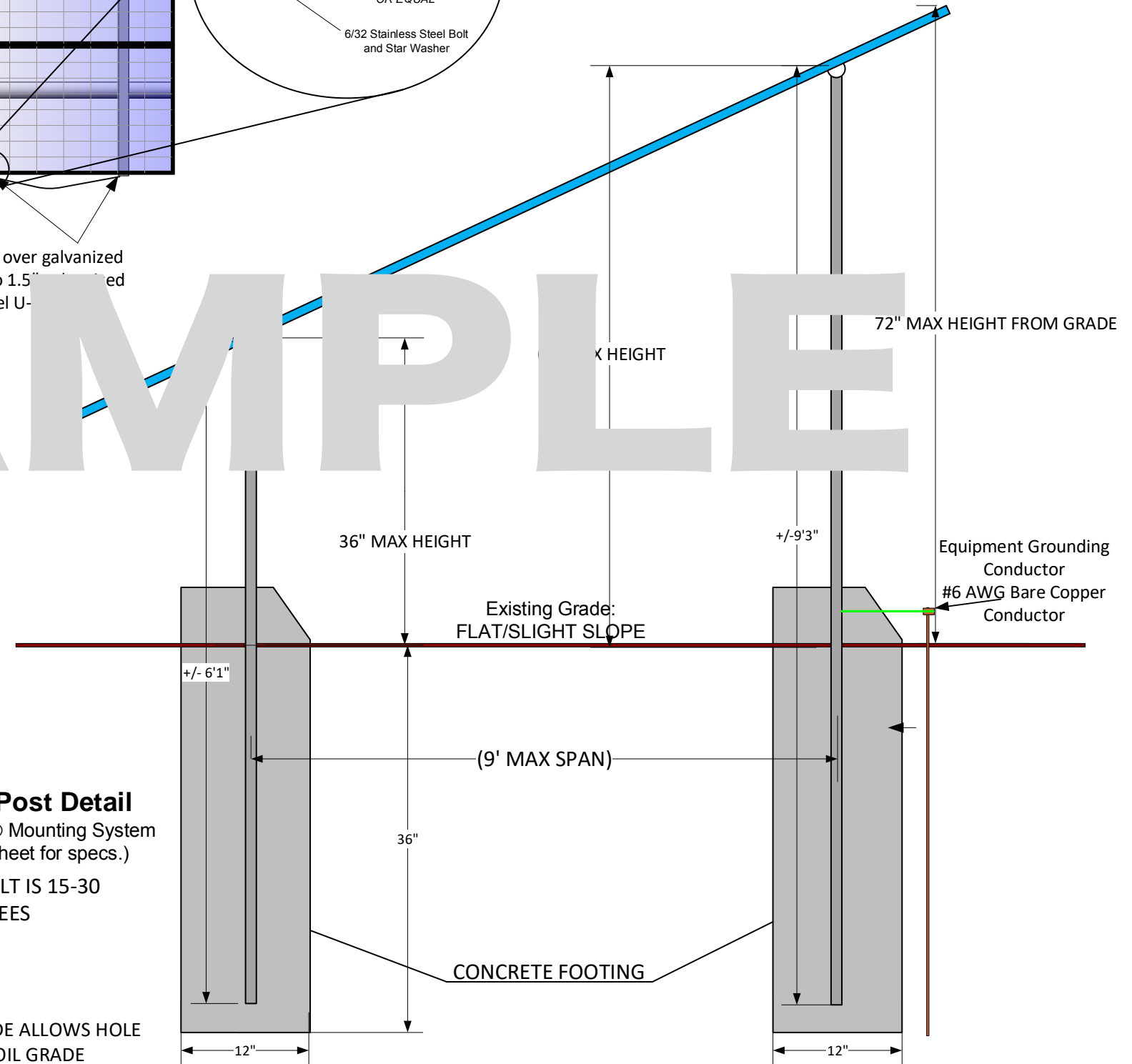

**Side View of Post Detail**  
ProSolar GroundTrac® Mounting System  
(See attached cut sheet for specs.)  
PROPOSED TILT IS 15-30 DEGREES

THE USE OF 12" HIGH SONOTUBES ABOVE GRADE ALLOWS HOLE DEPTH TO BE REDUCED TO 36" BELOW SOIL GRADE



DRAFTED BY:  
 B.S.  
 CHECK BY:  
 C.G.  
 DRAFTED:  
 2/9/18

OWNER BUILDER

10.44 kWDC  
 Photovoltaic  
 System

SHEET:  
 PV: 1.4 ©

# ATTACHMENT DETAIL

(36) Modules Ground Mount Array  
 Showing Placement of (14) Post Holes  
 (drawing not to scale)

NOTE: ARRAY PLACEMENT  
 IS NOT TO SCALE. SEE PV1.2  
 FOR LOCATIONS

## Mounting and Connection Detail

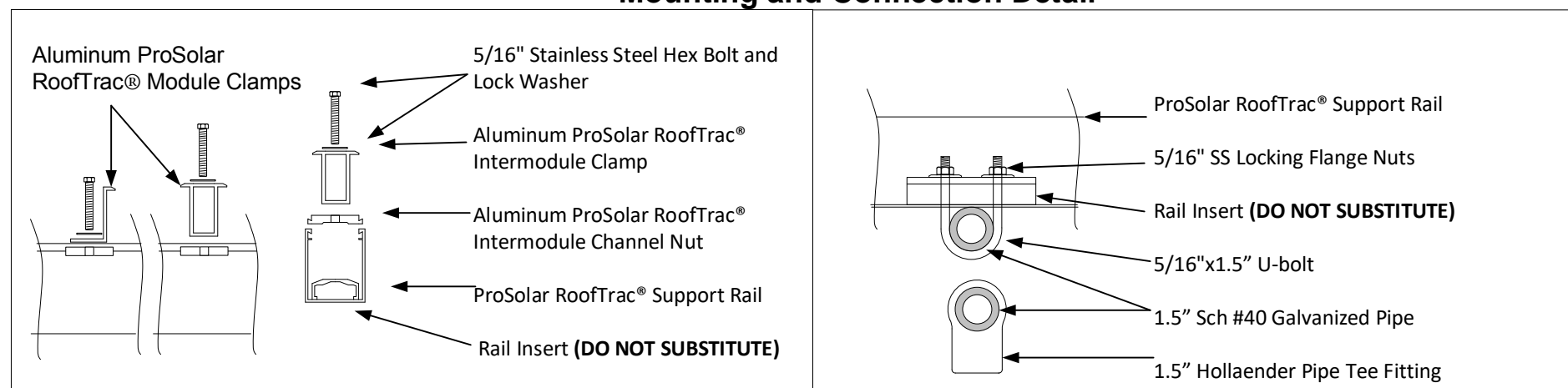

MODULE SPECIFICATIONS:			
BRAND	REC REC290TP2 BLK		
QUANTITY	36		
VOC STC	38.8 VDC	OTHER NOTES:	
VOC Temp	38.8 VDC	MODULE	
ISC STC	9.58 AMPS	(TCvOC=-.35%/C)	
IMP STC	9.05 AMPS		
DIMENSIONS	WIDTH= 39.25	HEIGHT= 65.94	
	WEIGHT= 40.8	DEPTH= 1' >, <2	

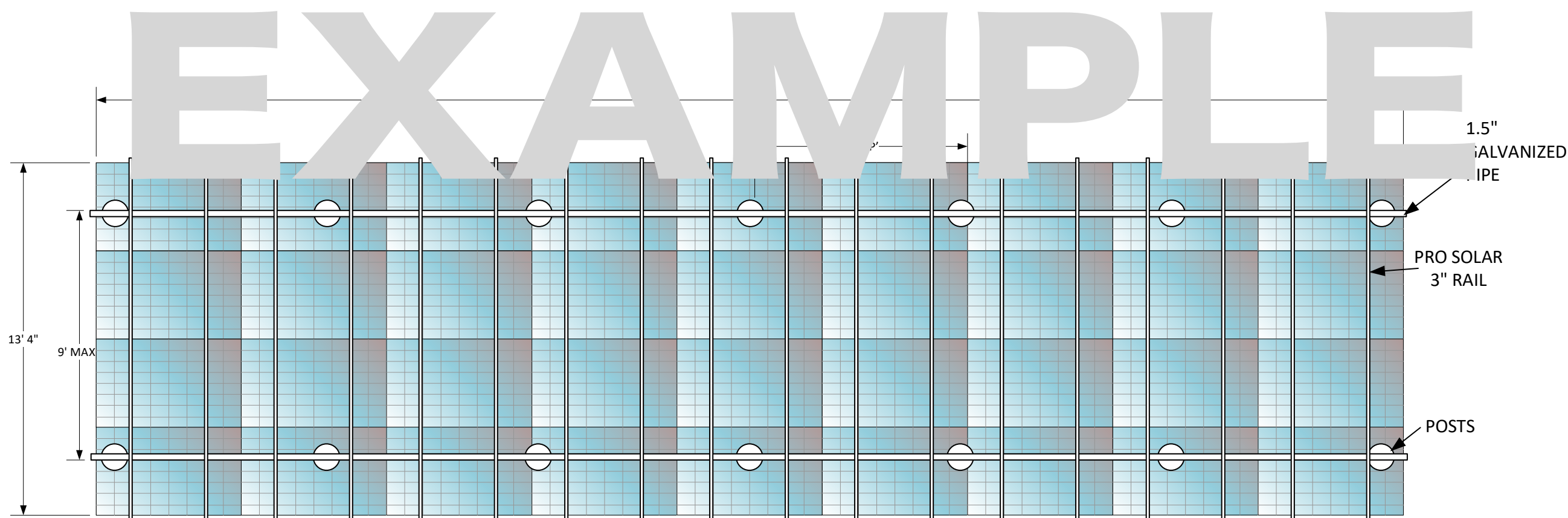



# SIGNAGE



DRAFTED BY:  
B.S.  
CHECK BY:  
C.G.  
DRAFTED:  
2/9/18

OWNER BUILDER

10.44 kWDC  
Photovoltaic  
System

SHEET:  
PV: 1.6



P1 PLACARD LOCATED ON DOOR OF MAIN SERVICE PANEL PER 705.10

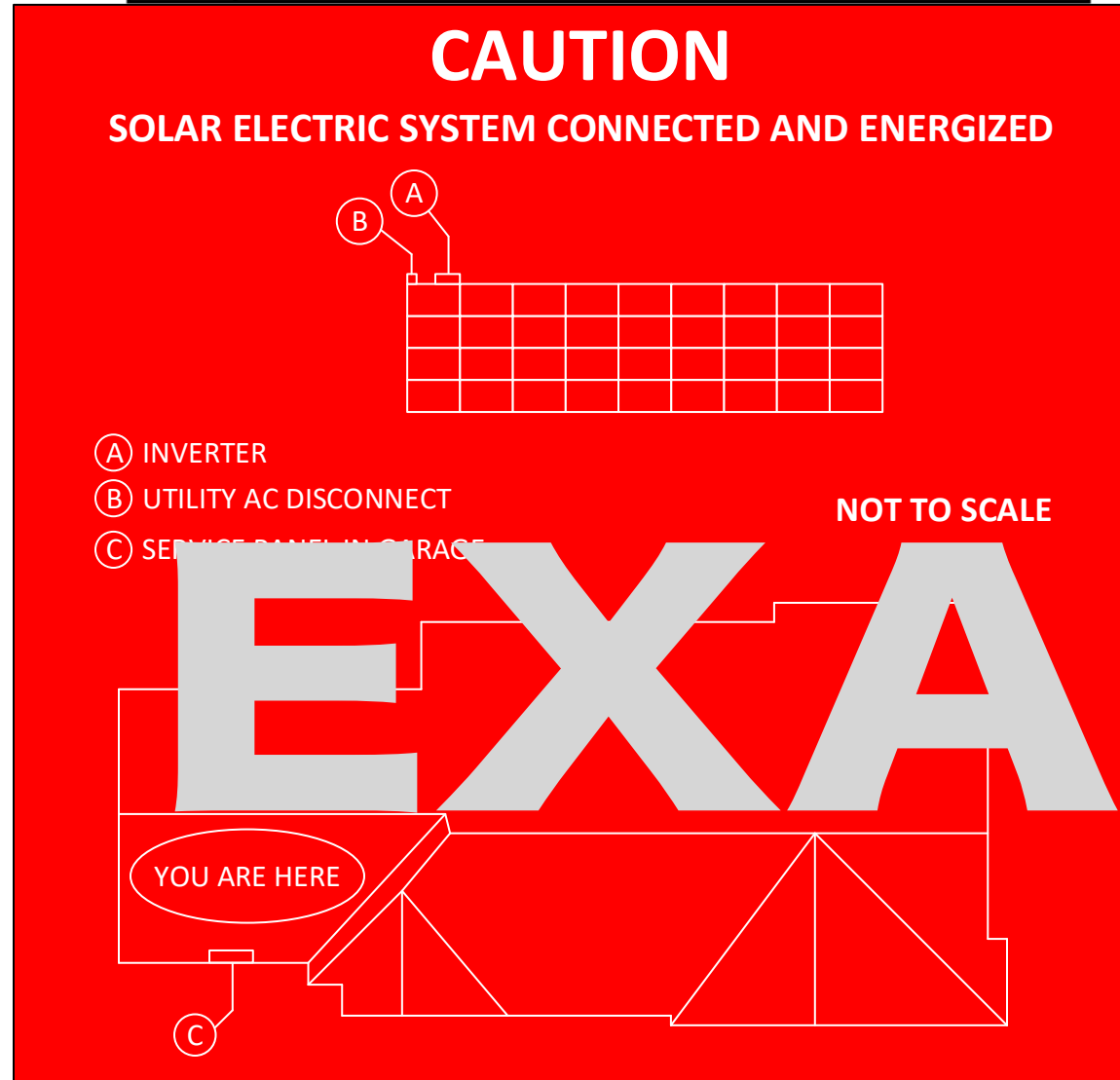

## NOTES:

-Alternate power source placard(Map) shall be plastic, engraved in a contrasting color to the plaque. This plaque will be attached by pop rivets or screws or other approved method. Durable adhesive materials must be suitable for the environment. If exposed to sunlight, it shall be UV resistant.

-All plaques and signage req. by 2014 NEC will be installed as req.

Signage and Labeling Specifications shall be:

- Red background with white lettering for caution signage.
- 3/8" letter heights
- All capital letters
- Reflective
- Arial or similar font, Non-Bold
- Weather resistant material (i.e. engraved plastic).

-Permanent labels shall be provided. No sharpie marker will be allowed within main service panel or subpanel.

(Placards and Stickers shown here are for illustration purposes only. Actual size will be compliant with the requirements of the jurisdiction in which they will be installed)

S2

**PHOTOVOLTAIC SYSTEM DC DISCONNECT**

OPEN- CIRCUIT VOLTAGE	350	VDC
OPERATING VOLTAGE	350	VDC
MAX PERMISSABLE SYS VOLTAGE	600	VDC
OPERATING CURRENT	32	AMPS AC
SHORT CIRCUIT CURRENT	14.97	AMPS
MAXIMUM POWER	10,440	WATTS STC

LABEL LOCATED ON INVERTER DC DISCONNECT PER 690.52

S4

**WARNING:**  
**INVERTER OUTPUT CONNECTION:**

...REL...  
...CURRE...  
...EVICE

...ATE...  
...NTERA...  
...POINT OF

...NTEH...  
...ON M...  
...OVE...  
...NT PROTECTION DEVI...  
...PER 69...

S4.1

**WARNING:**  
**ELECTRIC SHOCK HAZARD**

IF A GROUND FAULT IS INDICATED,  
THE NORMALLY GROUNDED CONDUCTORS  
MAY BE UNGROUNDED AND ENERGIZED

LABEL LOCATED ON INTEGRATED DC DISCONNECT PER 690.35(F)

S6

**PHOTOVOLTAIC SYSTEM**  
**EQUIPPED WITH RAPID SHUT DOWN**

LABEL LOCATED ON RAPID SHUT DOWN DISCONNECT SWITCH PER 690.12

S3

**PHOTOVOLTAIC SYSTEM**  
**AC DISCONNECT FOR UTILITY OPERATION**

CURRENT	32	AMPS AC
OPERATING VOLTAGE	240	VOLTS

LABEL LOCATED ON INTERACTIVE SYSTEM POINT OF INTERCONNECTION PER 690.54

S5

**WARNING:**  
**ELECTRIC SHOCK HAZARD**

TERMIN... AND LOAD SIDES  
MAY BE... SIZED IN THE OPEN POSITION

LABEL LOCATED ON PHOTOVOLTAIC SYSTEM DISCONNECTS WHERE THE LOAD TERMINALS MAY BE ENERGIZED IN THE OPEN POSITION PER 690.13(B)

S5.1

**WARNING:**  
**ELECTRIC SHOCK HAZARD**

THE DC CONDUCTORS OF THIS PHOTOVOLTAIC SYSTEM ARE UNGROUNDED AND MAY BE ENERGIZED

LABEL LOCATED ON INTEGRATED DC DISCONNECT PER 690.17

S7

**WARNING: PHOTOVOLTAIC**  
**POWER SOURCE**

LABEL LOCATED ON EXPOSED CONDUIT/RACEWAYS APPROX. EVERY 5', AT TURNS, ABOVE/BELOW PENETRATIONS AND AT ALL JUNCTION/COMBINER BOXES PER 690.31(G)(3)